

# Orta

## Corner unit pull-out system

A clever system designed for installation behind hinged doors, the Orta features squared shelves for maximum use of hidden corners.

With a reversible centre upright for left or right-hand mounting and individually pull-out rear shelves, it offers flexible, ergonomic access to items at the very back of the cabinet. Plus, the integrated Silent system for soft closing means a peaceful tidy-up every day.

APPLICATIONS

Blind corner cabinets in kitchens, sculleries and laundries



FEATURES	
Shelf styles & colours	Design line 400 - Flat wire shelf - anthracite Design line 200 - Solid side shelf - anthracite
Load capacity	7kg per front shelf   11kg per rear shelf
Front panel widths	450mm   500mm
Cabinet height	Minimum 575mm
Opening & closing function	Silent system for soft closing
Number of selves per set	4 clip on shelves - 2 front, 2 rear

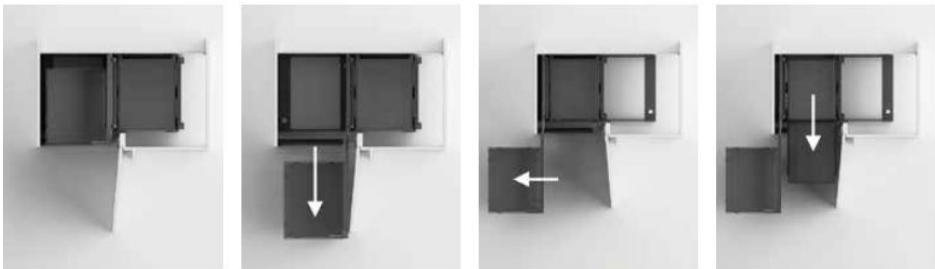

Sequence of movements - fitting is usable for left and right

DESIGNWITHHETTICH.CO.NZ

© Hettich New Zealand Limited, 2025 | Subject to modifications without notice